

MAIN FLOOR

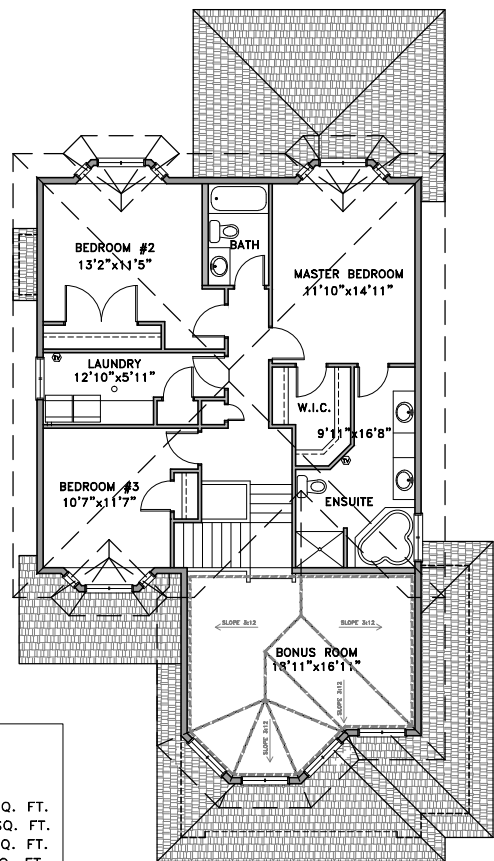

SECOND FLOOR

BEDROOMS - 3	
BUILDING AREA:	
MAIN FLOOR:	1,064 SQ. FT.
SECOND FLOOR:	1,020 SQ. FT.
BONUS ROOM:	311 SQ. FT.
TOTAL:	2,395 SQ. FT.
FINISHED BASEMENT:	
	1,056 SQ. FT.